

Mini Round 3-Wire Clearance Marker Lights



HD34003-3 Series



HD34003-3RSMD
3 LED



HD34003-3RCSMD
3 LED | Clear Lens



HD34003-3YSMD
3 LED



HD34003-3YCSMD
3 LED | Clear Lens



HD34003-3BCSMD
3 LED | Clear Lens

Product Specifications

PART NO:	HD34003-3RSMD	HD34003-3RCSMD	HD34003-3YSMD	HD34003-3YCSMD	HD34003-3BCSMD
LED:	3528 (Cree) SMD	3528 (Cree) SMD	3528 (Cree) SMD	3528 (Cree) SMD	3528 (Cree) SMD
COLOR:	Red	Red	Amber	Amber	Blue
DIMENSION:	1.09" x 0.5"	1.09" x 0.5"	1.09" x 0.5"	1.09" x 0.5"	1.09" x 0.5"
VOLT RANGE:	7.5 - 14 VDC	7.5 - 14 VDC	7.5 - 14 VDC	7.5 - 14 VDC	7.5 - 14 VDC
WATTAGE LOW:	0.13W @ 12V	0.13W @ 12V	0.13W @ 12V	0.13W @ 12V	0.12W @ 12V
WATTAGE HIGH:	0.60W @ 12V	0.60W @ 12V	0.62W @ 12V	0.62W @ 12V	0.5W @ 12V
LUMEN: RAW/EFFECTIVE	17.15/8.95 High 4.2/2.45 Low	7.15/8.95 High 4.2/2.45 Low	18.7/10.7 High 4.6/2.75 Low	18.7/10.7 High 4.6/2.75 Low	14.25/6.25 High 3.85/2.3 Low
AMP DRAW: HIGH/LOW	45mA/20mA	45mA/20mA	45mA/20mA	45mA/20mA	45mA/20mA

Product Features

- Super Bright 3 SMD
- Universal Design for Use as Auxiliary/Turn Marker or ID Light
- Compact Size for Easy Installation
- Flush Mount 3/4" Hole with Grommet Included
- Hard Wired with Bullet Terminal Connectors
- Polycarbonate Lens
- Epoxy Sealed PCB & Electronics
- Meets IP 67
- Three-Wire Design
- Bullet Terminals | 0.180" (4.57 mm)
- DOT/SAE FMVSS108 P2 PC
- CE, RoHS Compliant

Drawings

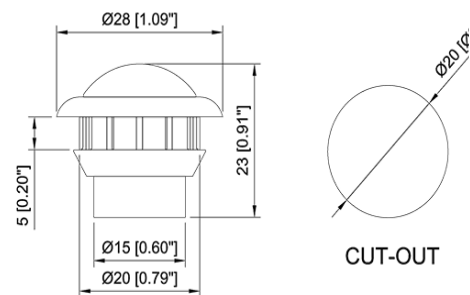

Additional Images

