

HD34103WSMD

LED Mini Round Flush Mount Utility Light



LED: 3 2835 SMD
COLOR: White
DIMENSION: 1.09" x 0.7"
VOLT RANGE: 7.5-14 VDC
AMP DRAW: 20mA

Product Specifications

- Super Bright 3 SMD
- Universal Design for Use as Auxiliary/Utility Marker or ID Light
- Compact Size for Easy Installation
- Flush Mount 3/4" Hole with Included Grommet
- Grommet Design Includes "Built-in Visor"
- 6" Sleeved Wires with Bullet Terminals
- SAE/DOT L, P2



HD34103WSMD
White Lens

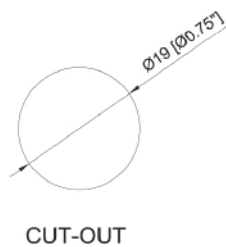
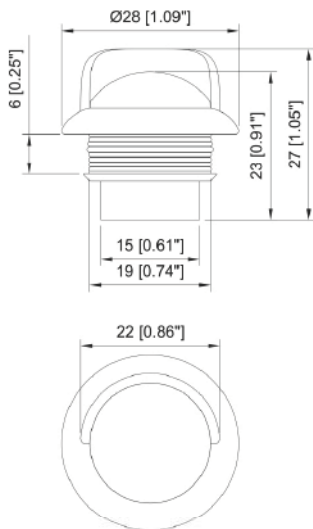

Heavy Duty Lighting
PO Box 82268
Portland, OR 97282
HeavyDutyLighting.com

Phone: 503 233 0008
Fax: 503 233 0009
Toll-Free 877 238 0008

